



GE PATIENT IMMOBILIZER INSTRUCTIONS FOR USE

The GE Patient Immobilizer allows staff to safely secure the wrists and legs during procedures where conscious sedation is administered. The patient's wrists can be safely attached to the leg wrap by using the squeeze clips and rapid adjustment webbing.

Indications for Use:

Use only on a procedure table during an operation using conscious sedation or anesthetization. This product is NOT intended to be used for Behavior Management.

Contraindications:

Not for "Behavior Management"; DO NOT use for a violent or confused patient.
DO NOT use if there is a dislocation or fracture on the immobilized limb, hip or torso.
DO NOT use if an IV or wound could be compromised by the device.

Cautions:

- Caution: Federal law restricts this device to sale by or on the order of a Physician.
- Patient must ALWAYS be monitored while this device is in use. DO NOT leave a patient unattended while this device is in use.
- Do not expose the product to flame, or temperatures above 120 degrees F.
- DO NOT use a damaged or soiled product. ALWAYS inspect product for damage before use.
- The least restrictive device should be used for immobilization. If the wrist immobilizers or the patient immobilizer is not required- don't use it.

Directions:

- 1) Secure the GE Patient Immobilizer under the mattress by wrapping the strap around the bottom of the table and attaching it to the Velcro strips.

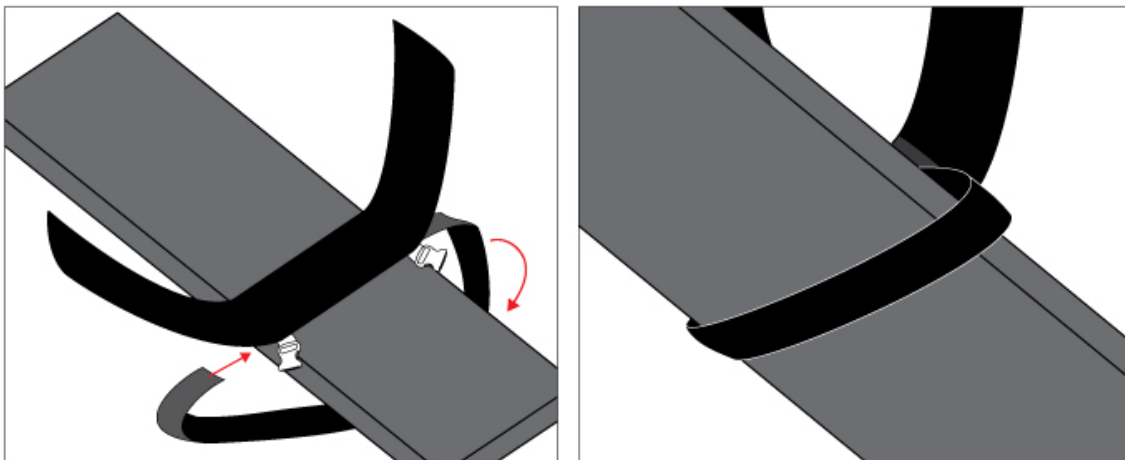



GE PATIENT IMMOBILIZER INSTRUCTIONS FOR USE

- 2) Position the patient as desired on the table.
- 3) Wrap the GE Patient Immobilizer around the patient ABOVE the knees. Secure using the hook-and-loop fasteners.

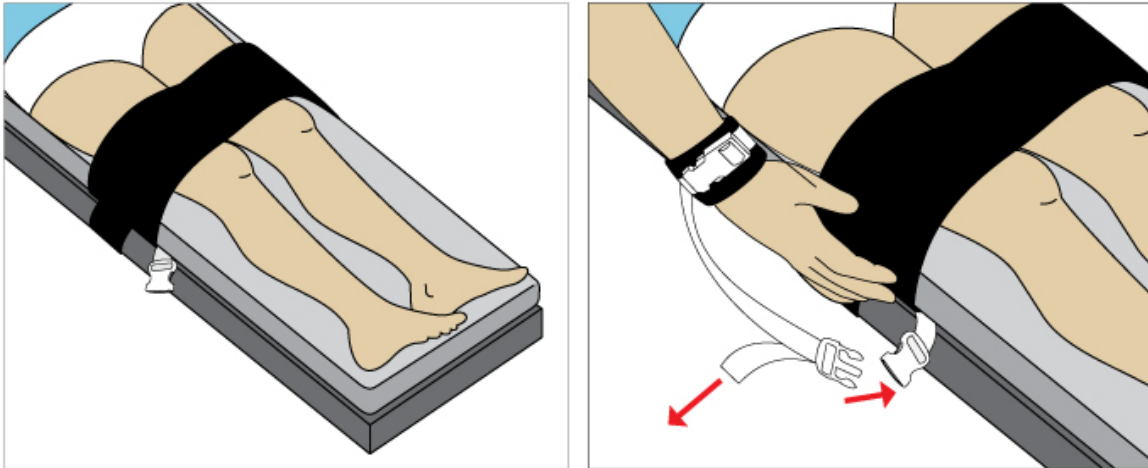

- 4) If Wrist Immobilizer(s) will be used; wrap around the patient's wrist and secure the hook-and-loop fasteners and the squeeze clip(s). Attach snugly but do not restrict circulation.
 - 5) Attach the Wrist Immobilizer(s) to the GE Patient Immobilizer using the squeeze clips and tighten the straps to secure the arm.
- MAKE SURE straps cannot tighten, loosen or slip during the procedure or when the table is adjusted.

- Frequently check for proper circulation and skin integrity.
- Wrist Immobilizers are single use only; discard after use. The GE Patient Immobilizer may be cleaned and reused.